

2015 SENATE GOVERNMENT AND VETERANS AFFAIRS

SB 2273

2015 SENATE STANDING COMMITTEE MINUTES

Government and Veterans Affairs Committee Missouri River Room, State Capitol

SB 2273
1/30/2015
Job # 22877

☐ Subcommittee
☐ Conference Committee

Committee Clerk Signature

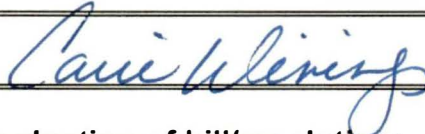

Explanation or reason for introduction of bill/resolution:

A BILL for an Act to provide an appropriation to the office of management and budget for constructing an addition to the state capitol building.

Minutes:

Attachments 1 -2

Chairman Dever: Opened the hearing on SB 2273.

Senator Sorvaag, District 45: Testified as sponsor and in support of the bill. This just an option and Senator Laffen will talk about the details. We are always looking for space and it is obviously fairly expensive space. It would be money out of the OMB general fund. If we are going to add on to the capitol it has to fit in and look right. The expense per sq. ft. would be high but it is about the same cost as the Supreme Court facility per sq. ft.

(1:40)**Chairman Dever:** Was there a conversation about this in the interim Government Services Committee?

Senator Sorvaag: No, the subject came up once but there was no conversation on it.

Chairman Dever: Does this extend out over the exterior of the building?

Senator Sorvaag: Yes over the loading dock area.

Chairman Dever: If we are looking at moving the judiciary out of the capitol building we are going to have some space for other purposes too.

Senator Sorvaag: You are correct. There are always others looking for space.

(3:58) **Al Jaeger, Secretary of State:** See Attachment #1 for testimony in support of the bill.

(12:18)**Chairman Dever:** I am curious, in looking at the layout, if the offices between your office and judicial, that appear to be Supreme Court offices, would become available if they vacated that?

Al Jaeger: I imagine. The justice's offices begin right to the east of my office.

Chairman Dever: I have always noticed that there are no doors down that hallway.

Al Jaeger: Yes, they have a back door. We have unmarked doors. My particular unmarked door takes you into the monkey room. That is the private entrance of the Secretary of State's office which I do not use.

Senator Flakoll: One of my issues is, from a security standpoint, that putting an addition over the loading dock would be a risk for a terrorist bomb. Has capitol security had a chance to weigh in on that?

Al Jaeger: The north parking lot was reconfigured for security measures, and I guess that could happen in theory. It is interesting that you brought up security. Of the elected officials on the main floor, I am probably the one who could get nailed the easiest. From that hallway to my office is about 6 feet. In my first years in office we kept that hallway door open all time and then we started closing it. If one of us is not there we usually lock that door now. We personally have been more conscious of potential problems. I have direct buttons to the Highway Patrol at my desk as well as my secretary. We have not had any dangerous people but we have had unique people come in to our office that have unique circumstances.

(17:10) Senator Laffen, District 43: See Attachment #2 for testimony in support of the bill. I think it is apparent that they need more space. It is my opinion that we will never move the Secretary of State out of this space because there is a history to the capitol general. The more you can have people together, the more efficient they are. It adds 2758 sq. ft. to the 5500 sq. ft. they have now. Normally a small addition would not work but in this case it works nicely.

(20:35) Senator Nelson: Are there really cement blocks showing on the back side? That looks absolutely awful. Wouldn't it be better to have two stories on there to get rid of it?

Senator Laffen: I am not sure if that is the final finished piece. It is Indiana limestone but it is just dirty. Another level could be done but the load would have to be approved. The offices on the next level are legislative council.

Senator Nelson: How many sq. ft. would be picked up if you include everything?

Senator Laffen: It is about 2000 sq. ft. that would be picked up. That would be a possibility to do internally if the Supreme Court justice moves out.

Chairman Dever: The bill says approximately 2000 sq. ft. and the proposed expansion is 2758, I wonder if there may not be the appearance, if they approve to build it, of having built larger than what was approved.

Senator Laffen: It can be amended to reflect the actual square footage.

Chairman Dever: I think that might be a good idea. Do you happen to know on a square footage basis how much the space per employee might compare to other agencies?

Senator Laffen: If they get to the 37 people without the addition, it would be about 149 sq. ft. per person in the Secretary of State's office.

Chairman Dever: There is a difference between offices and cubicles.

Senator Laffen: At least 1/3 of the space is circulation and only about half of that is useable space.

Chairman Dever: Mentioned looking for space for the legislators to have meetings. Closed the hearing on SB 2273.

2015 SENATE STANDING COMMITTEE MINUTES

Government and Veterans Affairs Committee

Missouri River Room, State Capitol

SB 2273
1/30/2015
Job # 22893

- ☐ Subcommittee
☐ Conference Committee

Committee Clerk Signature

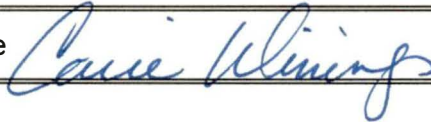

Minutes:

No Attachments

Chairman Dever: Opened SB 2273 for committee discussion.

Senator Cook: Moved a Do Not Pass.

Senator Poolman: Seconded.

Chairman Dever: I think that he needs more space but I think that the judicial wing might provide that solution.

Senator Poolman: Even the Secretary of State said that this was not his highest priority in terms of funding. He is much more worried about his software platform than he is his physical space.

Senator Cook: If we are going to spend over \$1 million on an addition to the capital building, I don't think the decision should first be made in this committee. I think there is a process that you follow where you look at the whole big picture. You look at all the needs of the capital and you figure out what the priority is.

Chairman Dever: I suggested that they don't throw the file away.

A Roll Call Vote Was Taken: 7 yeas, 0 nays, 0 absent.

Motion Carried.

Senator Flakoll will carry the bill.

Date: 1/30
Roll Call Vote #: 1

2015 SENATE STANDING COMMITTEE
ROLL CALL VOTES
BILL/RESOLUTION NO. "Enter Bill/Resolution No."

2273

Senate Government and Veterans Affairs Committee

☐ Subcommittee

Amendment LC# or Description: _____

Recommendation: ☐ Adopt Amendment
☐ Do Pass ☒ Do Not Pass ☐ Without Committee Recommendation
☐ As Amended ☐ Rerefer to Appropriations
☐ Place on Consent Calendar

Other Actions: ☐ Reconsider ☐ _____

Motion Made By Cook Seconded By Poolman + Nelson

Senators	Yes	No	Senators	Yes	No
Chairman Dever	✓		Senator Marcellais	✓	
Vice Chairman Poolman	✓		Senator Nelson	✓	
Senator Cook	✓				
Senator Davison	✓				
Senator Flakoll	✓				

Total (Yes) 7 No 0

Absent 0

Floor Assignment Flakoll

If the vote is on an amendment, briefly indicate intent:

REPORT OF STANDING COMMITTEE

SB 2273: Government and Veterans Affairs Committee (Sen. Dever, Chairman)
recommends **DO NOT PASS** (7 YEAS, 0 NAYS, 0 ABSENT AND NOT VOTING).
SB 2273 was placed on the Eleventh order on the calendar.

2015 TESTIMONY

SB 2273

ALVIN A. JAEGER
SECRETARY OF STATE

HOME PAGE www.nd.gov/sos



SECRETARY OF STATE
STATE OF NORTH DAKOTA
600 EAST BOULEVARD AVENUE DEPT 108
BISMARCK ND 58505-0500

January 30, 2015

#1
pg 1

PHONE (701) 328-2900
FAX (701) 328-2992

E-MAIL sos@nd.gov

TO: Senator Dever, Chairman, and Members of the Senate Government and Veterans Affairs Committee

FR: Al Jaeger, Secretary of State

RE: SB 2273 – Expansion of Secretary of State's office

The additional space of 2,758 square feet adjacent to our present office location would be very welcomed and facilitate the operations of the Secretary of State's office. The concept of this addition has been reviewed by the Capitol Grounds Planning Committee. I also shared this concept with the interim Government Services Committee on January 16, 2014.

As indicated by the plan, the office staff currently is located in three different spaces. In addition, it should be noted that the 2,780 square feet listed for the "main" space includes the office of the Secretary of State located across the hall, which is 932 square feet. Therefore, this square footage should be deducted from the 2,780 square feet listed for the "main" space leaving 1,848 square feet.

This adjusted square footage would more accurately reflect the amount of new space that would be added to accommodate the staff and office operations. It would be an increase of 149% over the existing space currently on the north side of the hall and free up the equivalent space in the two current J wing locations for other agencies

However, I also realize that with the new budget forecast, the expansion project's cost could be viewed as not being a high priority for utilization of space within the capitol.

Therefore, if it was decided to not fund the project immediately, maybe it would be possible to approve it subject to a triggering clause that would allow for its construction when a certain benchmark in state resources was achieved.

SUMMARY:

NEW EXPANSION IN EXISTING J-WING:

OLD EXPANSION IN J-WING:

MAIN SECRETARY OF STATE SPACE:

PROPOSED EXPANSION

1,790 SF

952 SF

2,780 SF

5,522 SF

2,758 SF

2,742
2,780
932
1,848

EXISTING SECRETARY OF STATE SPACE

PROPOSED EXPANSION

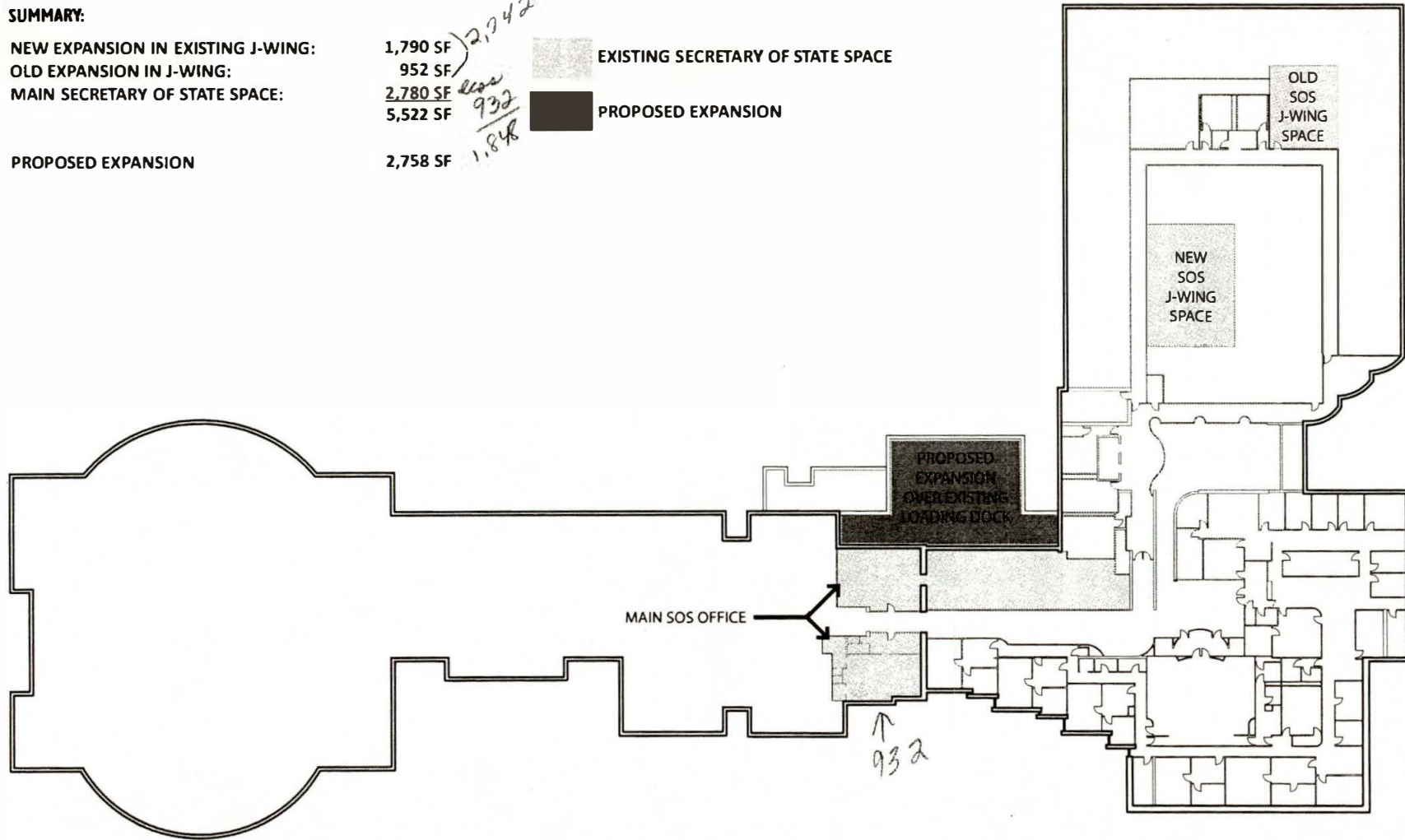

FIRST FLOOR - ND STATE CAPITOL BUILDING



SECRETARY OF STATE EXPANSION SPACE STUDY

JANUARY 2015

1/30 SB 2273 #1 pg 2



EXISTING



PROPOSED

COST ESTIMATE

				\$/GSF	COST
DIVISION 1 - GENERAL REQ.				\$54.39	\$150,000.00
DIVISION 2 - EXISTING CONDITIONS				\$12.69	\$35,000.00
DIVISION 3 - CONCRETE				\$12.20	\$33,653.00
DIVISION 4 - MASONRY				\$60.91	\$168,000.00
DIVISION 5 - METALS				\$39.20	\$108,117.06
DIVISION 6 - WOODS, PLASTICS & COMPOSITES				\$12.69	\$35,000.00
DIVISION 7 - MOISTURE PROTECTION				\$10.00	\$27,580.00
DIVISION 8 - OPENINGS				\$15.05	\$41,500.00
DIVISION 9 - FINISHES				\$40.00	\$110,320.00
DIVISION 10 - SPECIALTIES				\$2.54	\$7,000.00
DIVISION 11 - EQUIPMENT				\$0.00	\$0.00
DIVISION 12 - FURNISHINGS				\$0.00	\$0.00
DIVISION 13 - SPECIAL CONSTRUCTION				\$0.00	\$0.00
DIVISION 14 - CONVEYING EQUIPMENT				\$0.00	\$0.00
SUBTOTAL GENERAL BUILDING CONSTRUCTION				\$259.67	\$716,170.06
DIVISION 21 - FIRE SUPPRESSION				\$45.00	\$124,110.00
DIVISION 22 - PLUMBING				\$0.00	\$0.00
DIVISION 23 - HEATING, VENTILATION & AC				\$0.00	\$0.00
DIVISION 25 - INTEGRATION AUTOMATION				\$0.00	\$0.00
DIVISION 26 - ELECTRICAL				\$30.00	\$82,740.00
DIVISION 27 - COMMUNICATIONS				\$0.00	\$0.00
DIVISION 28 - ELECTRONIC SAFETY SECURITY				\$0.00	\$0.00
SUBTOTAL MECHANICAL & ELECTRICAL				\$75.00	\$206,850.00
DIVISION 31 - EARTHWORK				\$0.00	\$0.00
DIVISION 32 - EXTERIOR IMPROVEMENTS				\$0.00	\$0.00
DIVISION 33 - UTILITIES -				\$0.00	\$0.00
DIVISION 34 - TRANSPORTATION				\$0.00	\$0.00
DIVISION 35 - WATERWAY AND MARINE CONSTRUCTION				\$0.00	\$0.00
SUBTOTAL SITE IMPROVEMENTS				\$0.00	\$0.00
CONTINGENCY	15.0%			\$50.20	\$138,453.01
TOTAL ESTIMATED CONST. COST				\$384.87	\$1,061,473.07
Total GSF					2,758.00

SUMMARY:

NEW EXPANSION IN EXISTING J-WING: 1,790 SF
OLD EXPANSION IN J-WING: 952 SF
MAIN SECRETARY OF STATE SPACE: 2,780 SF
5,522 SF

PROPOSED EXPANSION 2,758 SF

EXISTING SECRETARY OF STATE SPACE
PROPOSED EXPANSION

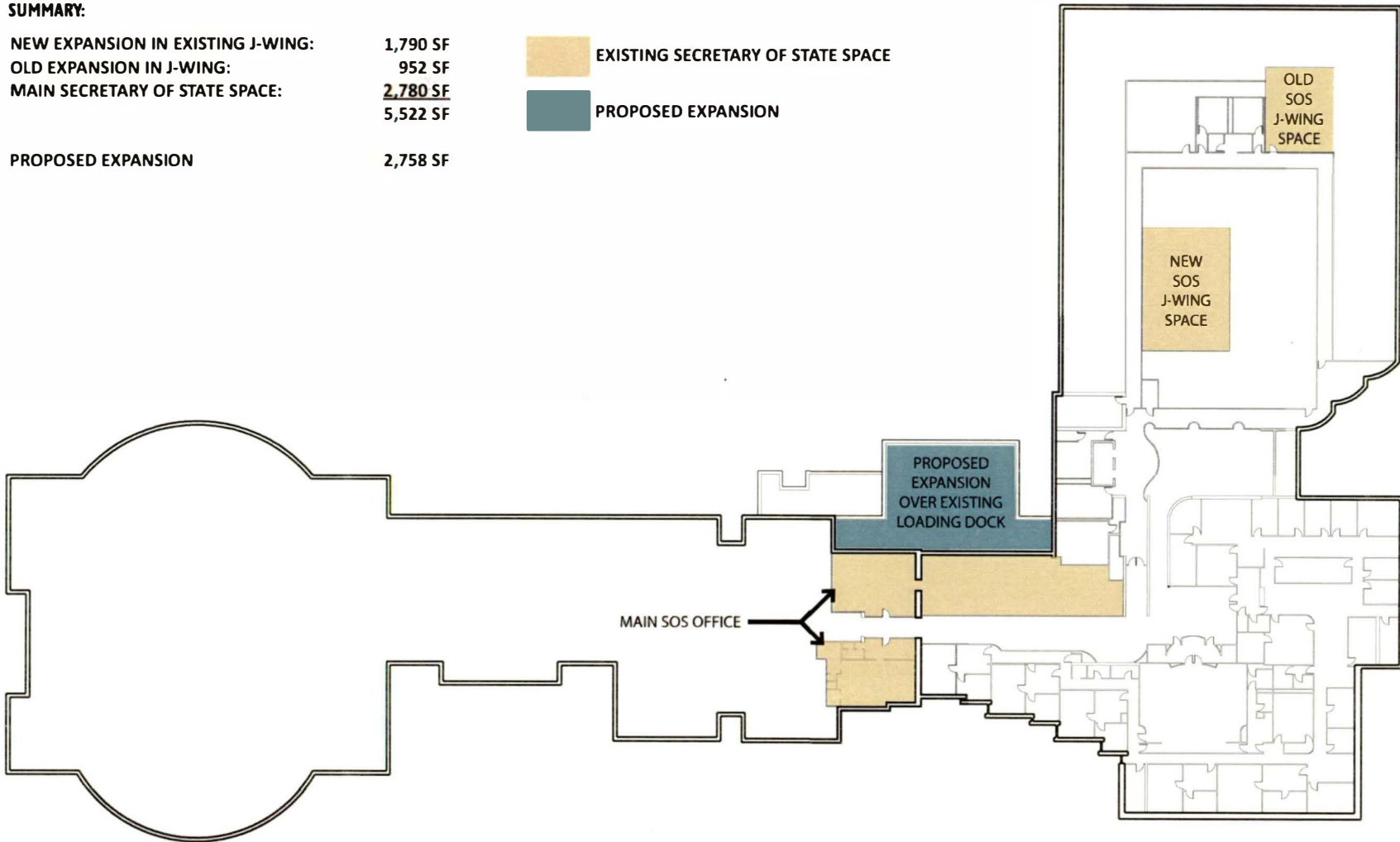

FIRST FLOOR - ND STATE CAPITOL BUILDING



SECRETARY OF STATE EXPANSION SPACE STUDY
JANUARY 2015

1/30 SB 2013

#2 Pg 1

EXISTING



PROPOSED



COST ESTIMATE

					\$/GSF	COST
DIVISION 1 - GENERAL REQ.					\$54.39	\$150,000.00
DIVISION 2 - EXISTING CONDITIONS					\$12.69	\$35,000.00
DIVISION 3 - CONCRETE					\$12.20	\$33,653.00
DIVISION 4 - MASONRY					\$60.91	\$168,000.00
DIVISION 5 - METALS					\$39.20	\$108,117.06
DIVISION 6 - WOODS, PLASTICS & COMPOSITES					\$12.69	\$35,000.00
DIVISION 7 - MOISTURE PROTECTION					\$10.00	\$27,580.00
DIVISION 8 - OPENINGS					\$15.05	\$41,500.00
DIVISION 9 - FINISHES					\$40.00	\$110,320.00
DIVISION 10 - SPECIALTIES					\$2.54	\$7,000.00
DIVISION 11 - EQUIPMENT					\$0.00	\$0.00
DIVISION 12 - FURNISHINGS					\$0.00	\$0.00
DIVISION 13 - SPECIAL CONSTRUCTION					\$0.00	\$0.00
DIVISION 14-CONVEYING EQUIPMENT					\$0.00	\$0.00
SUBTOTAL GENERAL BUILDING CONSTRUCTION					\$259.67	\$716,170.06
DIVISION 21 - FIRE SUPPRESSION					\$45.00	\$124,110.00
DIVISION 22 - PLUMBING					\$0.00	\$0.00
DIVISION 23 - HEATING, VENTILATION & AC					\$0.00	\$0.00
DIVISION 25 - INTREGATION AUTOMATION					\$0.00	\$0.00
DIVISION 26 - ELECTRICAL					\$30.00	\$82,740.00
DIVISION 27 - COMMUNICATIONS					\$0.00	\$0.00
DIVISION 28 - ELECTRONIC SAFETY SECURITY					\$0.00	\$0.00
SUBTOTAL MECHANICAL & ELECTRICAL					\$75.00	\$206,850.00
DIVISION 31 - EARTHWORK					\$0.00	\$0.00
DIVISION 32 - EXTERIOR IMPROVEMENTS					\$0.00	\$0.00
DIVISION 33 - UTILITIES -					\$0.00	\$0.00
DIVISION 34 - TRANSPORTATION					\$0.00	\$0.00
DIVISION 35 - WATERWAY AND MARINE CONSTRUCTION					\$0.00	\$0.00
SUBTOTAL SITE IMPROVEMENTS					\$0.00	\$0.00
CONTINGENCY	15.0%				\$50.20	\$138,453.01
TOTAL ESTIMATED CONST. COST					\$384.87	\$1,061,473.07
Total GSF						2,758.00

1/30 SB 2273 #2 pg 2